

Copy router for aluminium and pvc profiles

With a manual vertical milling unit is conceived to carry out the milling.....
A wide range of working operations can be carried out with the vertical milling unit (see working examples on the reverse).

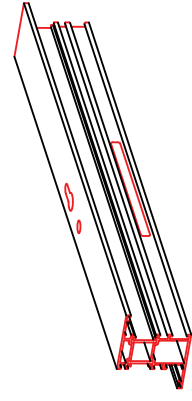

1) Lock cut-out on aluminium profile

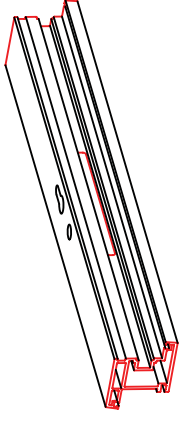

2) Lock cut-out on PVC profile

Optional equipment



1) Vertical unit handling lever: recommended to work aluminium (A20)



2) Lateral supports L=1/2/2,5m with 6+6 stop devices on bars with metric ruler (can't be used together with 3)

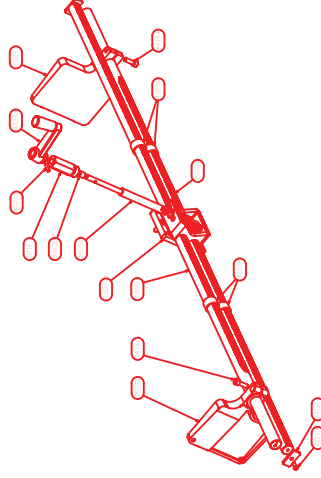

3) Profile centring device unit (can't be used together with 2)

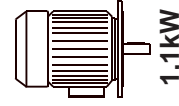
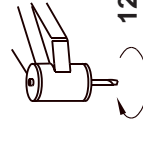

12.000rpm
110V



3+T+N
400Volt



6-8Bar

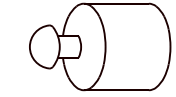

Collet CM2A

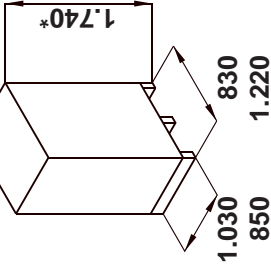

A20 136kg
A21 145kg

1.030 850 1.220
1.740* 830



Code 104200
(104200N+502411)

The Company reserves the right to amend and improve its products without notice.

Functioning

- 1) The profile is clamped at low pressure;
 - 2) By pushing simultaneously the pneumatic buttons placed on the handles of the right and left levers, the high pressure clamping is activated and the mist sprayer and vertical motor are set in motion; The bimanual control device is certified and complies with the safety regulations in force.
- The motor is equipped with a thermic feeler that stops the feeding in case of overheating, protecting the integrity of the motor itself.

Start button of the pneumatic 4-diameter copy pin: 5-6-8-10

Revoler with 4 stop devices of the vertical descent (revoler with 8 stops is optional)

6+6 foldaway stop devices on the lateral supports in 3 available lengths (1/2/2,5m)

