

1) Lock cut-out on aluminium profile

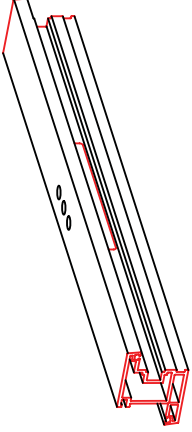

2) Cut-out for handle and its mechanism on steel reinforced pvc

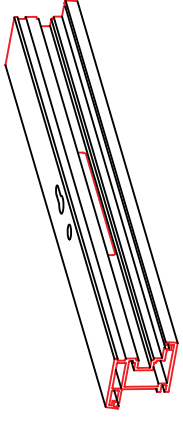

3) Lock cut-out on pvc profile

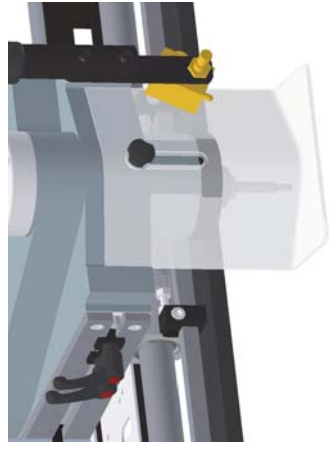

1) Coolant mist-sprayer: needed to work aluminium



2) Vertical unit handling lever: recommended to work aluminium

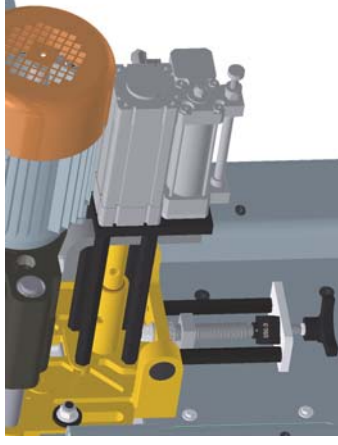

3) Display to visualize the drilling unit position from the working table

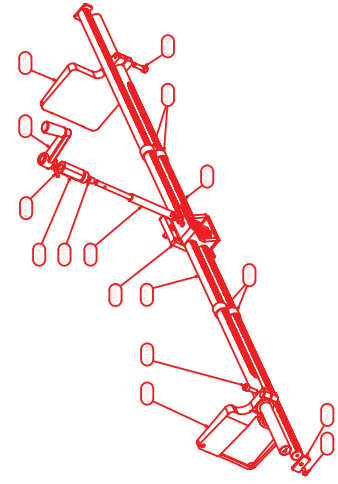

4) Profile centring device unit (can't be used together with 5)



5) Lateral supports L=1/2/2,5m with 6+6 stop devices on bars with metric ruler (can't be used together with 4)

CE

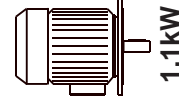

12.000rpm

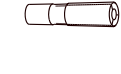

Collet CM2



6-8Bar

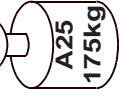
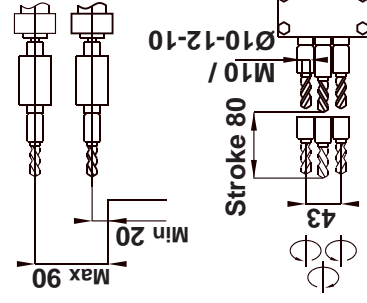

1,1kW
2.800rpm (Alu)
900rpm
(Pvc + Steel)

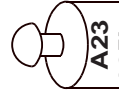
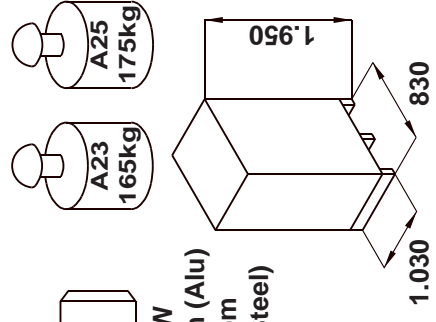

A23
165kg

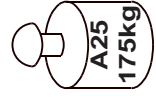

A25
175kg

Copy router for aluminium and pvc profiles

With a manual vertical milling unit and a horizontal drilling unit with manual (A23) or oil-pneumatic (A25) feed. Conceived to carry out the milling with the vertical unit and the triple drilling with the horizontal unit on aluminium and steel reinforced pvc for the inserting of a window handle with just one clamping without turning the profile. A wide range of working operations can be carried out with the vertical milling unit (see working examples on the reverse).



Code 104230S
(104230N+502240+502411)



Revolver with 4 stop devices of the vertical descent (revolver with 8 stops is optional)

Four-diameters pneumatic copy pin: 5-6-8-10

Start button of the pneumatic copy pin

6+6 foldaway stop devices on the lateral supports in 3 available lengths (1/2/2,5m)

Functioning

- 1) The profile is clamped at low pressure;
 - 2) By pushing simultaneously the pneumatic buttons placed on the handles of the right and left levers, the high pressure clamping is activated and the (optional) mist sprayer and vertical motor are set in motion;
 - 3) By pushing simultaneously the pneumatic buttons placed on the right and left sides of the working table (A25), the drilling cycle begins: the horizontal motor is set in motion.
- On the A23 the drilling cycle is activated by pushing simultaneously the buttons on the left lever (vertical descent) and the one on the right lever (drilling unit feed).
- The bimanual control device is certified and complies with the safety regulations in force. Each motor is equipped with a thermal feeler that stops the feeding in case of overheating, protecting the integrity of the motor itself.